

OVIDREL[®]

(choriogonadotropin alfa injection)

A step-by-step guide to your OVIDREL[®] Pen

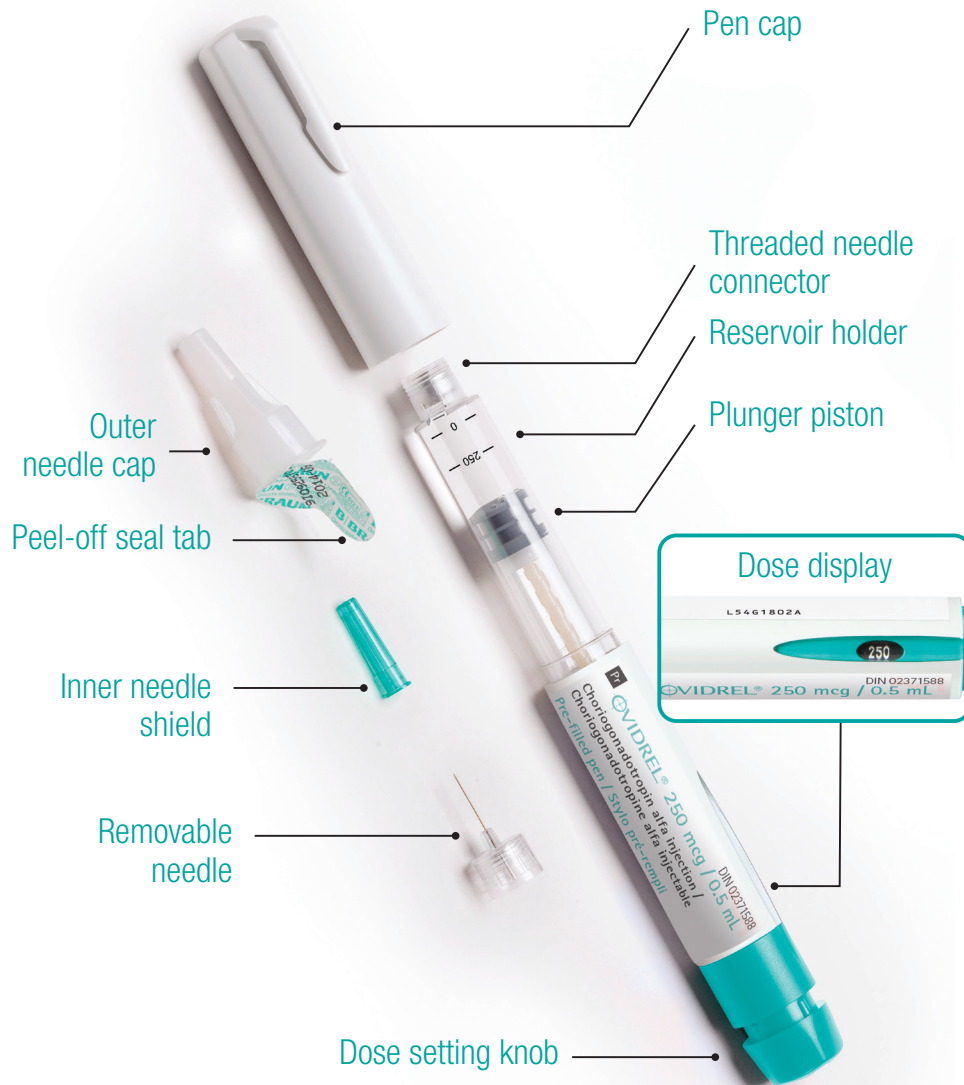

OVIDREL Pen available in:

- 250 mcg



For illustrative purposes only.
This does not represent the Canadian approved OVIDREL Pen.

**EMD
SERONO**

About OVIDREL

What is OVIDREL?

OVIDREL is the only recombinant human chorionic gonadotropin (r-hCG). Its generic name is choriogonadotropin alfa.

OVIDREL is produced as a solution in a pre-filled syringe or a pre-filled pen that is intended for subcutaneous injection. OVIDREL ensures that you are receiving the highest purity hCG on the market. Subcutaneous injections offer the advantage of being convenient and easy to self-administer.

What is OVIDREL used for?

OVIDREL is used to trigger ovulation in infertile women (patients) with ovarian dysfunction.

What is the amount of OVIDREL that must be injected?

250 mcg in a pre-filled pen.

Should I be concerned about interactions with other medications?

Please inform your doctor and pharmacist if you are taking or have taken any other medications, even those not requiring a prescription.

What are the main side effects I could see with OVIDREL therapy?

As with other hCG preparations, side effects can occur with the use of OVIDREL: discomfort at the injection site, stomach pain, nausea, and vomiting have been reported. Ask your fertility team to discuss the possible side effects with you. As with all medications, it is important to report any physical changes and all symptoms to your healthcare professional.

How do I know my injection is complete?

After your injection, check that the dose display reads "0". This confirms that your dose has been fully delivered. Do not attempt to inject a second time. **In case dose display doesn't show "0", please contact your doctor.**

What is the risk of developing OHSS while on OVIDREL?

Contact your doctor if you experience severe pain or bloating in the stomach or pelvic area, severe upset stomach, vomiting, or weight gain, as these are symptoms of a medical event called Ovarian Hyperstimulation Syndrome (OHSS). OHSS occurs infrequently (usually less than 3% incidence). However, because OHSS can progress rapidly to a serious medical event, OVIDREL should be stopped at the first signs of OHSS.

Is OVIDREL associated with multiple births and congenital birth defects?

Reports of multiple births have been associated with fertility treatments. You should discuss the potential risk of multiple births with your doctor before beginning treatment.

There is no evidence to establish an association between the administration of OVIDREL to female patients (patients) and the occurrence of congenital anomalies in their offspring.

How should I store my OVIDREL Pen at home?

- Refer to the date indicated on the labels for expiry date. Do not use after expiry date
- Solutions of pre-filled pens are stored at 2–8°C (in a refrigerator)
- Do not freeze. Protect from light. Store in original package
- Do not use the OVIDREL pen if the solution contains particles or is not clear

Step 1: Before you start using your OVIDREL pen



- Wash your hands with soap and water. It is important that your hands and all materials are as clean as possible
- On a clean surface, (e.g., clean table or kitchen surface) lay out everything you will need:



- 1 OVIDREL pen
- 2 One removable injection needle
- 3 Alcohol swabs*
- 4 Sharps disposal container* (not shown)

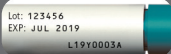

IMPORTANT! Verify the **expiration date** on the label – do not use expired medication.

* not supplied with product

STEP 2: Getting your OVIDREL Pen ready for injection

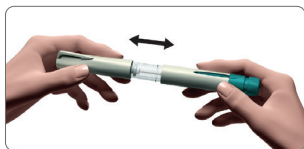

- Take off the pen cap



- Wipe the end of the threaded tip (containing the rubber centre) using an alcohol swab
- Look carefully at the reservoir holder; check that the reservoir holder is clear and does not contain particles

IMPORTANT! If the reservoir holder is cracked or if the solution is discoloured or cloudy, obtain a new pen. Contact your clinic or pharmacist for further instruction.

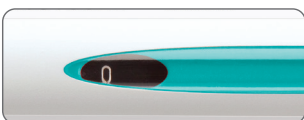

- Verify that the dose display is set to "0"



IMPORTANT! If the peel-off seal is damaged or loose, do not use the needle. Throw it away in a sharps disposal container, and get a new needle.

- Prepare your needle for injection
 - Get a new needle – only use the "single-use" needles supplied
 - Hold the outer needle cap firmly
 - Check that the peel-off seal on the outer needle cap is not damaged or loose
- Remove the peel-off seal

STEP 3: Attach the needle



- Press the threaded tip of the OVIDREL Pen into the outer needle cap, and twist clockwise until you feel a light resistance

IMPORTANT! Do not attach the needle too tightly, as it may be difficult to remove the needle after the injection.

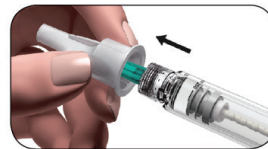

- Remove the outer needle cap by pulling it straight off – put it aside for later use
- Do not throw away the outer needle cap; you will need it for removing the needle from the pen



- Hold the OVIDREL Pen with the needle pointing upwards
- Carefully remove and discard the green inner shield

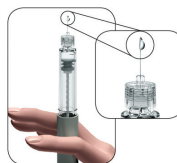

Look closely at the tip of the needle for a tiny drop of fluid. If you see a tiny drop, proceed to Step 4: Setting the dose to 250.

If you do not see a tiny drop of fluid at (or near) the needle tip, please refer to the section *Preparing your OVIDREL Pen*.

STEP 4: Setting the dose to 250

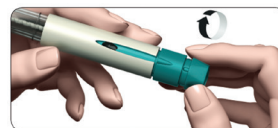

- Gently turn the dose setting knob clockwise; the dose display will show a straight line and you have to keep turning until you can read the number "250"

IMPORTANT! Do not push or pull the dose setting knob while you turn it.

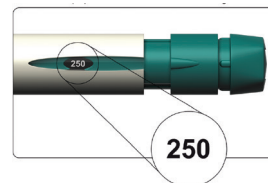

- If not already done, carefully remove the inner needle shield

IMPORTANT! Check that the dose display shows "250" before you move to the next step.

Step 5: Injecting your dose

- Choose an injection site in the area your doctor or nurse has told you to give the injection, such as your upper thigh or abdomen
- Clean the skin by wiping the area (about the size of a teabag) with an alcohol swab; allow the site to dry and set the alcohol swab to the side
- Check again to make sure the dose display reads “250”; if it does not, you must adjust it (see *Step 4: Setting the dose to 250*)

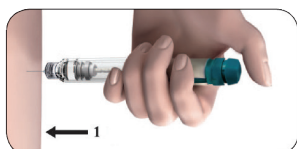

- Inject the dose as you were trained to do by your doctor or nurse:
 - Hold the pen in one hand, use your other hand to gently squeeze the skin together to make a raised area at the injection site
 - Insert the needle at a 90° angle into the skin. You might bend the needle if you do not insert it at a 90° angle
 - Press the dose knob down as far as it will go and hold it to complete the full injection

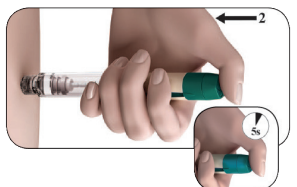

- Hold the dose knob down for a minimum of 5 seconds to ensure you inject the full dose

IMPORTANT! Do not release the dose setting knob until you have removed the needle from your skin.

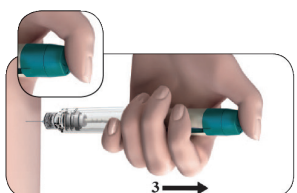

- After at least 5 seconds, keeping the dose setting knob pressed down, remove the needle from your skin
- Then release the dose setting knob
- The dose number shown in the dose display will turn back to “0”; this shows that the complete dose was delivered
- Use your alcohol swab to gently apply pressure where you have just injected

STEP 6: After the injection

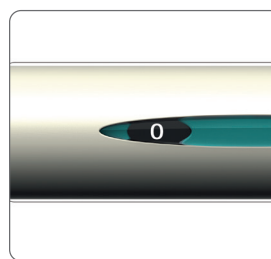

- Check to make sure you have given the complete injection – the dose display should show “0”
- This confirms that your dose has been fully delivered; do NOT attempt to inject a second time

IMPORTANT! If the dose display does not show “0”, please contact your doctor.

Removing the needle after injection:

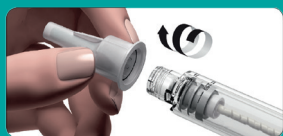
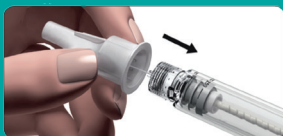

- Hold the pen firmly by the reservoir holder
- Carefully put the outer needle cap back onto the needle; be careful not to prick yourself with the needle
- Grip the outer needle cap and unscrew the needle by turning counter-clockwise; dispose of the used needle safely
- Remember: use the needle and pen only once and never share needles



IMPORTANT!

When the pen is empty, ask your pharmacist how to dispose of it – medicines should NOT be disposed of via wastewater or household waste.

Preparing your OVIDREL Pen



If you do not see a tiny drop, do the following:

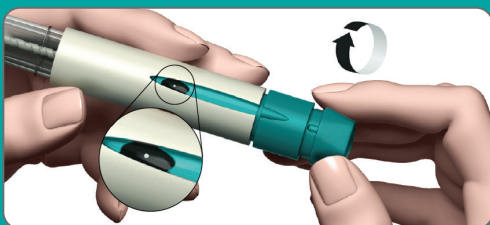

1. Gently turn the dose setting knob clockwise until you see a dot (•) in the dose display; if you pass this position, simply turn the dose setting knob back to the dot (•)
2. Hold the pen with the needle pointing upward
3. Tap the reservoir holder gently
4. Press the dose setting knob as far as it will go. A tiny drop of fluid will appear at the tip of the needle; this shows that your pre-filled pen is ready for injection
5. If you do not see any liquid, you may try a second time (up to a maximum of two times) starting from Step 1 of this section



You are not alone.

Where can you get help and find more information?

momentum

The *MOMENTUM* patient services program is a free and confidential service that offers customized patient support, including injection assistance, to individuals using EMD Serono fertility products.

 fertility.mymomentum.ca

Our comprehensive patient website is designed to provide:

- Technical support including videos and downloadable injection guides
- Frequently asked questions on EMD Serono products

 **1-800-387-8479**

- Our *MOMENTUM* toll-free helpline is available 24 hours a day, 7 days a week
- Regular hours are 8:00 a.m. to 8:00 p.m. (Eastern Time), Monday to Friday
- An after-hour pager service is available for urgent inquiries that cannot wait until the following business day. Simply leave your name, reason for calling, and your phone number, and a registered nurse will return your call in a timely manner

MOMENTUM is available in over 250 languages
through the assistance of certified translators.

MOMENTUM will not comment on individual diagnosis or treatment questions, or laboratory results. You should discuss those with your healthcare provider. *MOMENTUM* is a source of educational support sponsored by EMD Serono, Canada, and is not intended to replace discussions with your healthcare provider.



**OVIDREL**[®]
(choriogonadotropin alfa injection)

Reference: OVIDREL[®] Product Monograph. EMD Serono, March 25, 2022

OVIDREL[®] is a registered trademark of Merck KGaA, Darmstadt, Germany.
Importer & Distributor: EMD Serono, A Division of EMD Inc., Canada
A business of Merck KGaA, Darmstadt, Germany
2695 North Sheridan Way, Suite 200, Mississauga, Ontario L5K 2N6 Canada



 MEMBER OF
INNOVATIVE MEDICINES CANADA

**EMD
SERONO**

CA-HCG-00006 RH0261B